



SOHO HOUSE BERLIN  
Private events



Torstrasse 1, 10119, Berlin, Germany

T: +49 (0) 30 40 50 44 400

E: [events@sohohouseberlin.com](mailto:events@sohohouseberlin.com)

# Welcome

Situated in the centrally located Mitte district, known for its art galleries and restaurants, Soho House Berlin has a selection of private event spaces suited to everything from meetings and small gatherings to private screenings and parties. If you'd like to have food served at your event, choose from House Regulars or create a tailored menu to complement the occasion.





## TORSTRASSE I AND II

Invite your guests to a party or presentation in this space with a terrace overlooking Torstrasse and Alexanderplatz. Make the most of the large room and its fully equipped bar and sound system, or split the space into two smaller rooms and use the projector and screen for a meeting.

**TORSTRASSE I AND II** 282 SQ M  
 Projector and screen, Wi-Fi, sound system, microphones

SET-UP Standing Seated

CAPACITY 400 180

**TORSTRASSE I** 143 SQ M  
 Projector and screen, Wi-Fi, sound system, microphones

SET-UP Standing Seated

CAPACITY 200 80

**TORSTRASSE II** 139 SQ M  
 Projector and screen, Wi-Fi, sound system, microphones

SET-UP Standing Seated

CAPACITY 200 80

**TERRACE** 38 SQ M

SET-UP Standing

CAPACITY 60



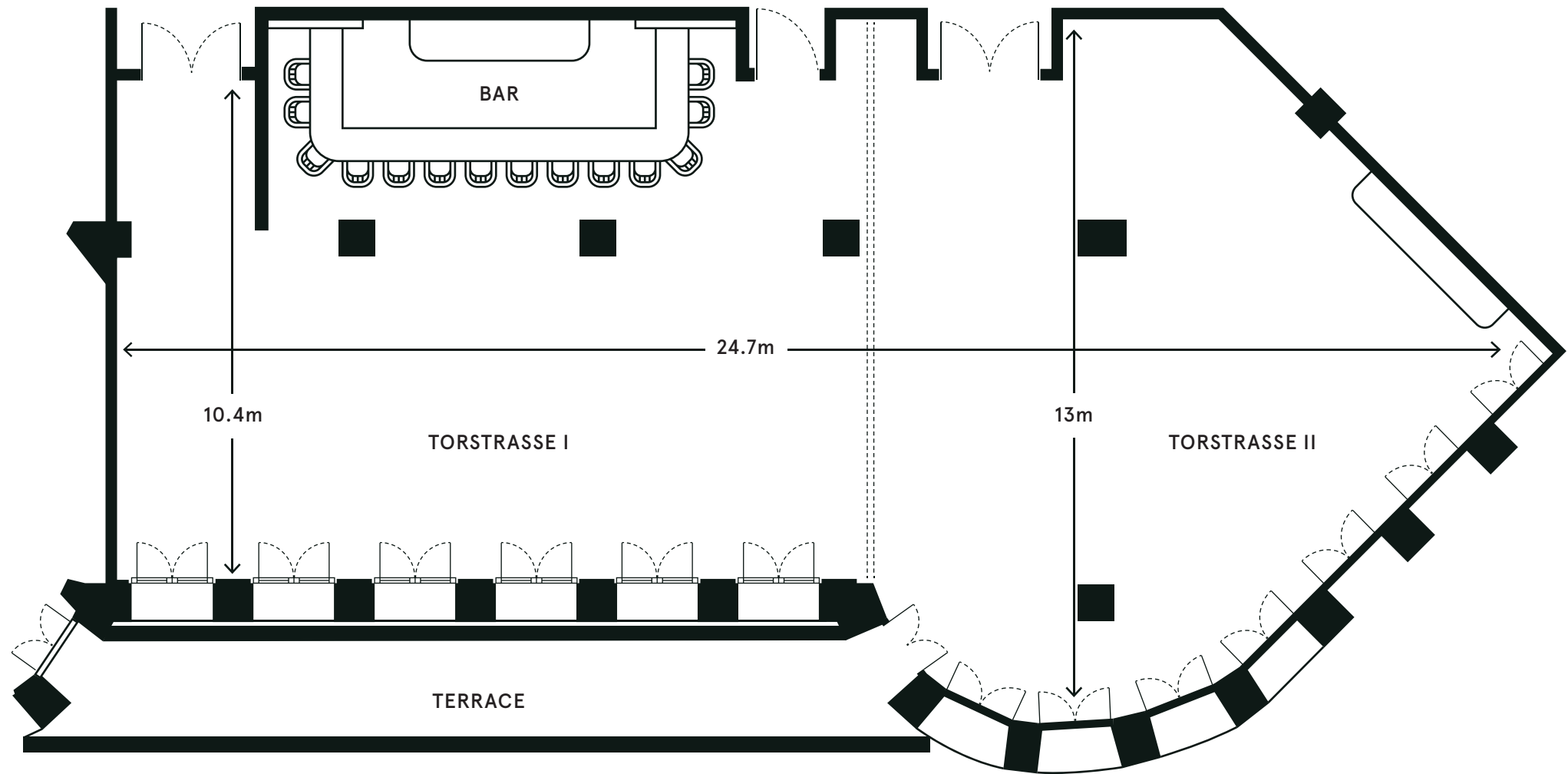

TORSTRASSE I AND II



## POLITBÜRO

Located in the building's former office space, this large room centres around a circular bar, and features a dining area and a terrace overlooking Torstrasse.



**FOYER** 32 SQ M

**BAR** 38 SQ M

**DINING ROOM** 56 SQ M  
 Projector, screen, Wi-Fi, sound system, microphones

**SET-UP** Standing Seated

**CAPACITY** 150 60

**TERRACE** 38 SQ M

**SET-UP** Standing

**CAPACITY** 60





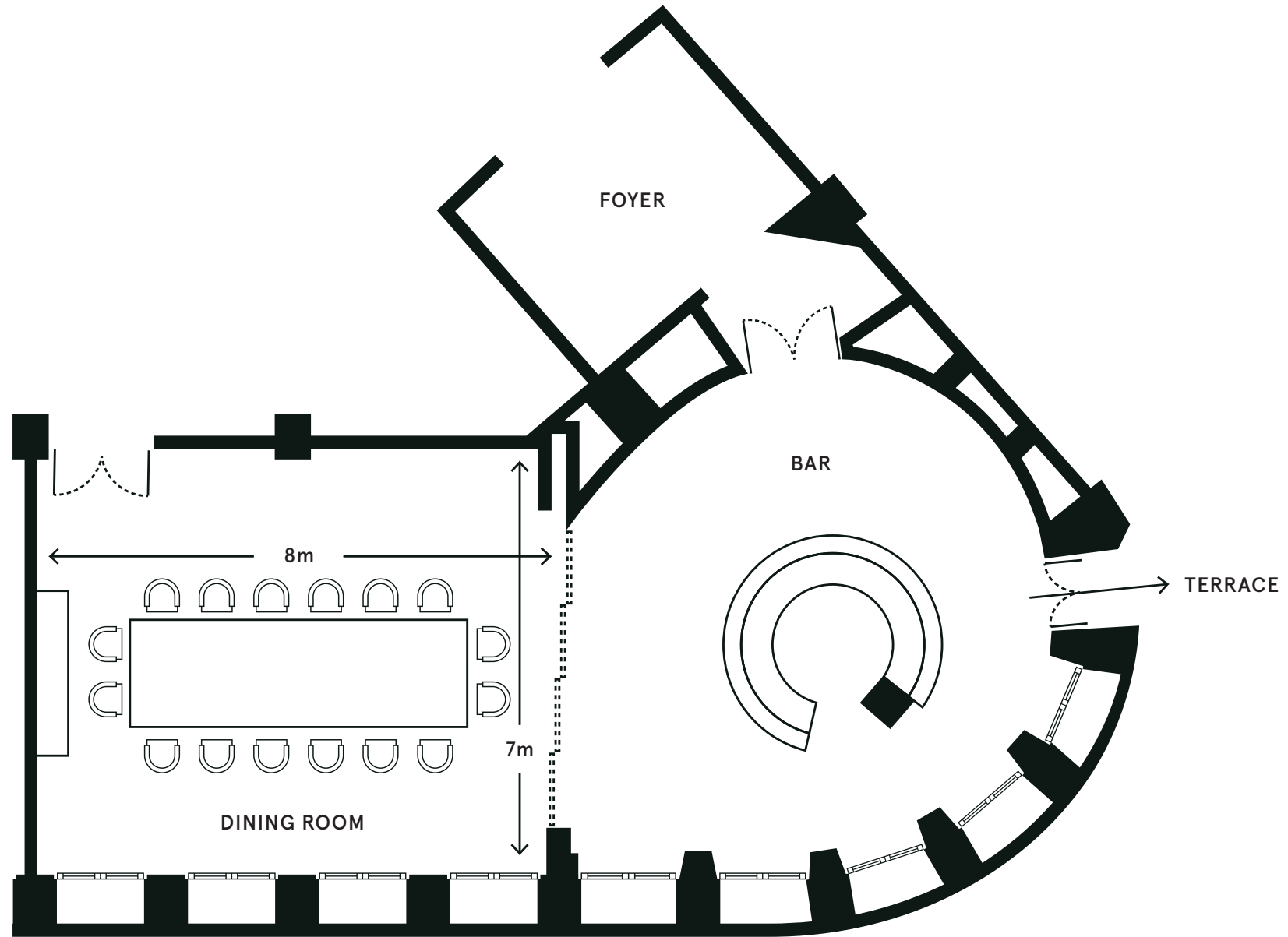



## CLUB ROOM

Facing the courtyard, this wood-panelled space features warm-toned interiors and a large table that seats up to 14 people. Make the most of its fully stocked bar during your meeting or private dining experience.

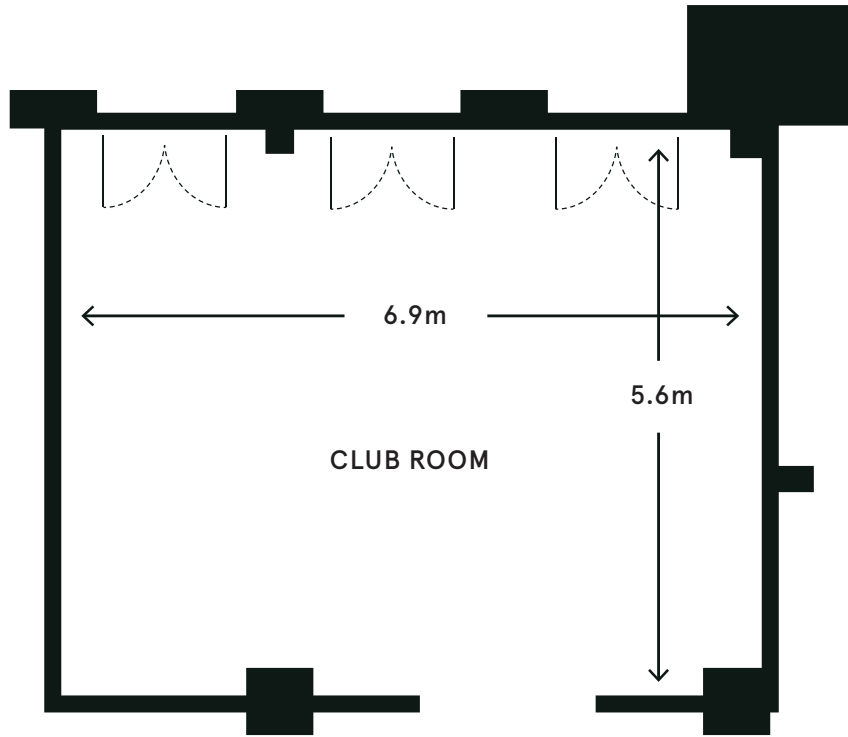

<b>CLUB ROOM</b>	39 SQ M
TV with HDMI connection, Wi-Fi, sound system	
<b>SET-UP</b>	Seated
<b>CAPACITY</b>	14



### THE RED ROOM AND SCREENING ROOM

The Red Room and screening room are neighbouring spaces that feature velvet furnishings and vibrant red shades throughout. Hire the Red Room alone to enjoy the fully stocked bar and a selection of art and design books, or use the space before and after a private viewing or presentation in the screening room.

### THE RED ROOM

100 SQ M

Projector, screen, Wi-Fi, sound system, microphones

---

SET-UP	Standing	Seated
--------	----------	--------

---

CAPACITY	120	40
----------	-----	----

---

### SCREENING ROOM

60 SQ M

---

SET-UP	Seated
--------	--------

---

CAPACITY	30
----------	----

---

DIGITAL FORMATS: DCP (2D and 3D), Blu-ray, DVD, Digital Betacam, HDMI and VGA interfaces for Mac and PC

---



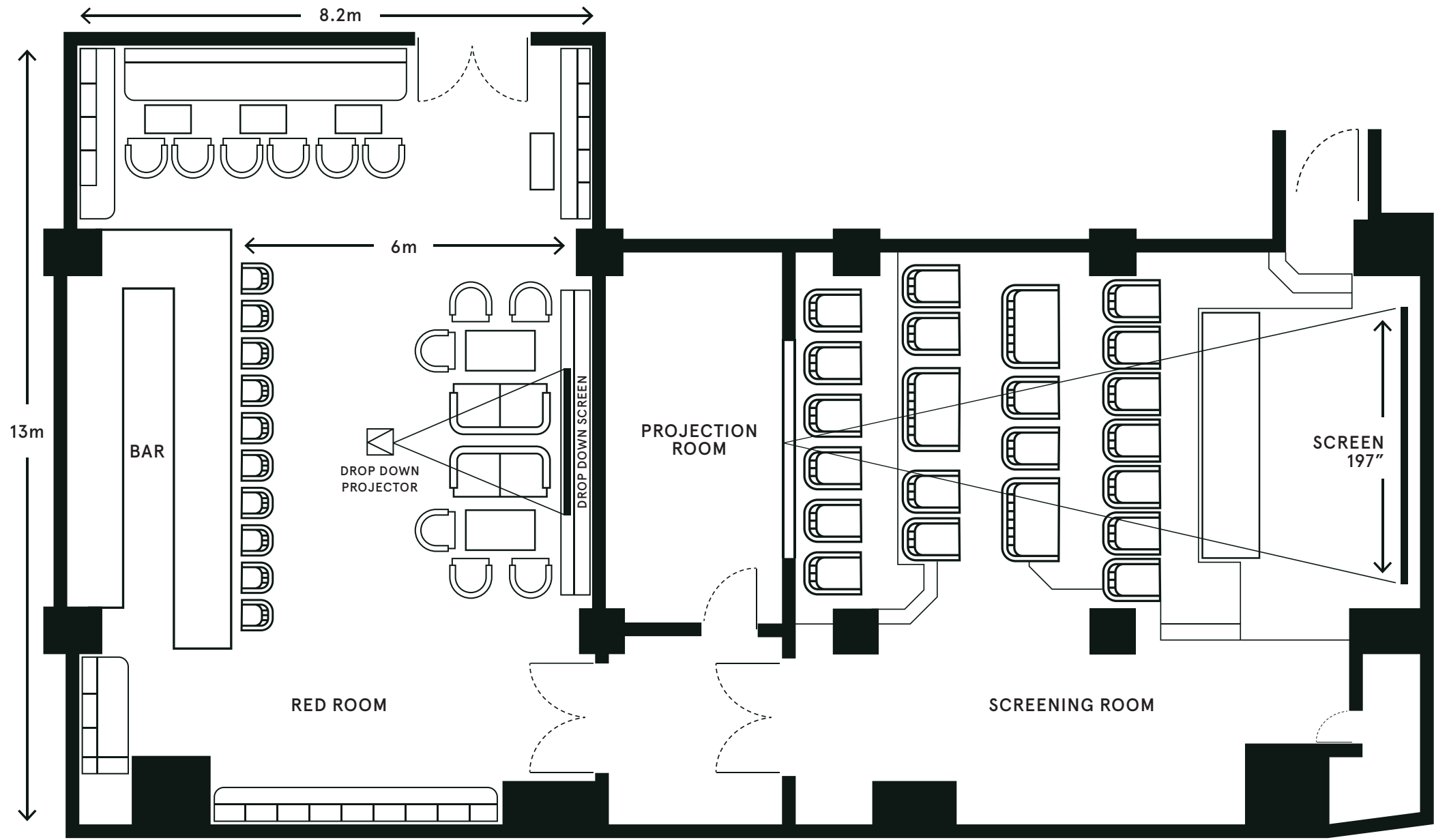

THE RED ROOM AND SCREENING ROOM



## COWSHED

Take over the Cowshed spa and unwind with friends and family in one of the treatment rooms, mani-pedi chairs, relaxation pods, sauna, or steam room.



## ABOUT US

We have Soho Houses all over the world, from Miami and Mumbai to Berlin and Barcelona, plus a number of public restaurants, townhouses, screening rooms, retail offerings, and workspaces.

## CONTACT US

Telephone: +49 (0) 30 40 50 44 400  
Email: [events@sohohouseberlin.com](mailto:events@sohohouseberlin.com)

[sohohouse.com](http://sohohouse.com)

